

Current part is item (1) on diagram. Available at www.oshkoshequipment.com

(1)	(2)	(3)	TM9-2320-211-34P			(4)	(5)	(6)	(7)	(8)	(9)	(10)
SMR Code	Federal Stock Number	DESCRIPTION	UNIT	of meas	inc. allowance	allowance	allowance	allowance	alw	maint	per 100 equip	alw per (a) Figure No.
												(b) Item No.
Reference Number & Mfr. Code	Usable On Code		(a)	(b)	(c)	(a)	(b)	(c)	cnt-	equipNo.		
1506-FIFTH ASSEMBLY												
P-O-R	2510-809-77	FIFTH WHEEL ASSEMBLY: 11640352 (19207)	EA	1	*	*	*	*	*	*	120	1
X1-F		BASE ASSEMBLY: 11640347 (19207)	EA	1	*	*	*	*	*	*	120	2
P-F	3120-179-73	BUSHING:ROCKER SHAFT 1163170-1 (19207)	EA	2	*	*	*	*	*	*	120	3
P-F	2510-809-77	SHAFT:ROCKER 11640343 (19207)	EA	1	*	*	*	*	*	*	120	4
P-F	5305-719-52	SCREW:WALKING BEAM MS90727-122 (96906)	EA	1	*	*	*	*	*	*	120	5
P-F	4730-172-00	FITTING,LUBRICATION:LATERAL MS15003-4 (96906)	EA	6	*	*	*	*	*	*	120	6
P-F	5310-957-50	NUT:WALKING BEAM 8742289 (19207)	EA	1	*	*	*	*	*	*	120	7
P-F	5310-584-52	WASHER,LOCK:WALKING BEAM MS35338-48 (96906)	EA	1	*	*	*	*	*	*	120	8
P-F	5305-939-92	SCREW,CAP,HEXAGON:WEDGE MS90725-190 (96906)	EA	2	*	*	*	*	*	*	120	9
X1		1506-FIFTH WHEEL WASHER:WEDGE 11640399 (19207)	AG	EA	2	*	*	*	*	*	120	10
P-F	5310-584-78	WASHER,LOCK:WEDGE SCREW MS35338-51 (96906)	AG	EA	2	*	*	*	*	*	120	11
P-F	2510-426-89	WEDGE:FIFTH WHEEL BASE ADJUSTING 7089514 (19207)	AG	EA	2	*	*	*	*	*	120	12
X1		SUB-BASE ASSEMBLY: 11640344 (19207)	AG	EA	1						120	13
P-F	3120-179-73	BUSHING:LATERAL SHAFT 111663710-2 (19207)	AG	EA	2	*	*	*	*	*	120	14
P-O	5305-725-41	SCREW,CAP,HEXAGON: SUB-BASE ASSEMBLY MS90726-163 (96906)	AG	EA	10	*	*	*	*	*	120	15
P-O	5310-800-06	WASHER:SUB-BASE ASSEMBLY MS35335-39 (96906)	AG	EA	10	*	*	*	*	*	120	16
P-F	2510-809-77	SHAFT:LATERAL	AG	EA	1	*	*	*	*	*	120	17
P-F		SUB-BASE:FIFTH WHEEL 11640344-1 (19207)	AG	EA	1	*	*	*	*	*	120	18
P-F	2510-750-99	SPRING:FIFTH WHEEL BASE LEVELING 7409902 (19207)	AG	EA	2	*	*	*	*	*	120	19

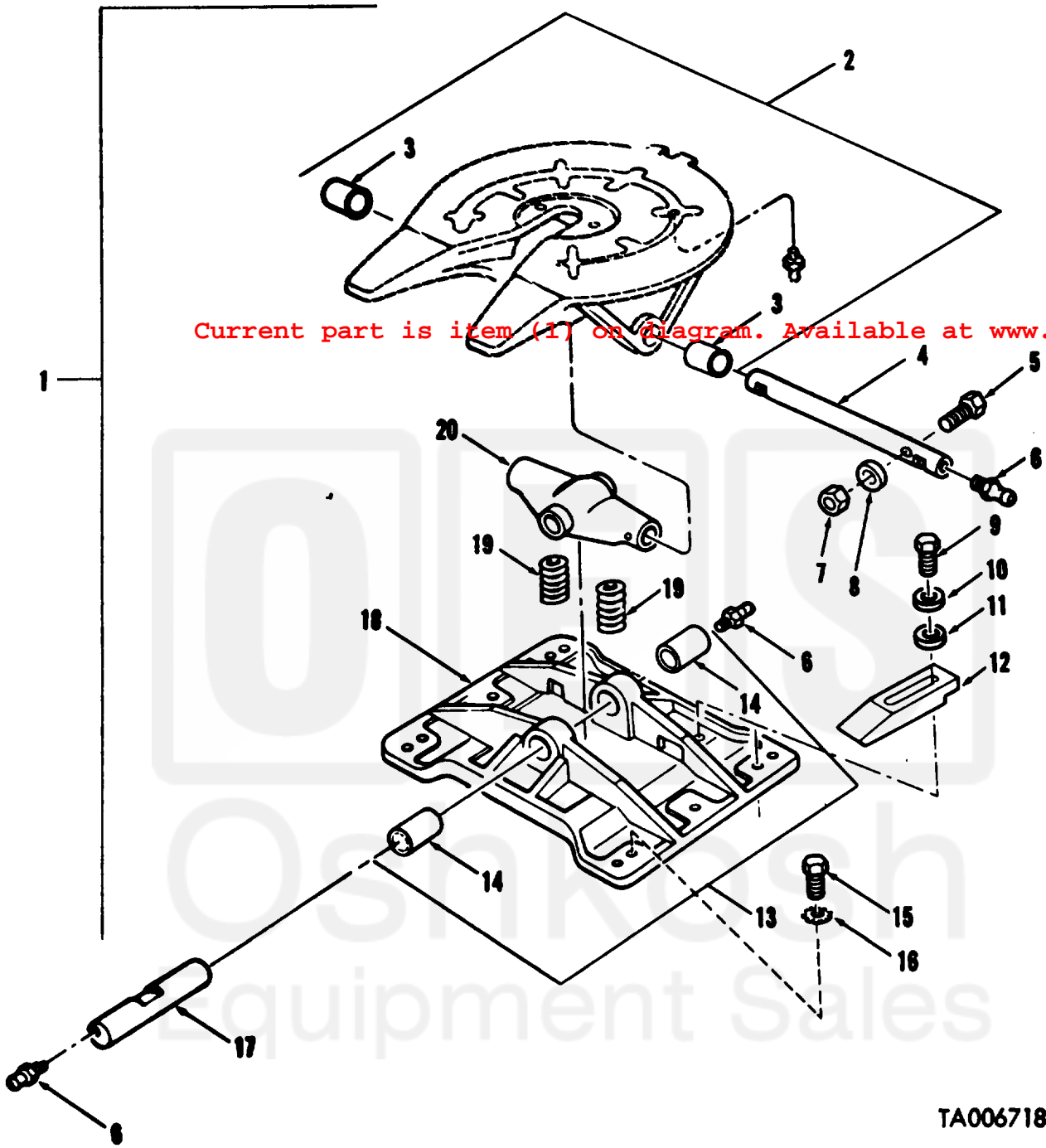

TA006718

Figure 120. Fifth wheel assembly-exploded view (2 of 2).